

Chainage	Existing Levels	Proposed Levels	Level Difference
24500	245.00	245.00	0.00
24510	244.80	244.80	0.00
24520	244.60	244.60	0.00
24530	244.40	244.40	0.00
24540	244.20	244.20	0.00
24550	244.00	244.00	0.00
24560	243.80	243.80	0.00
24570	243.60	243.60	0.00
24580	243.40	243.40	0.00
24590	243.20	243.20	0.00
24600	243.00	243.00	0.00
24610	242.80	242.80	0.00
24620	242.60	242.60	0.00
24630	242.40	242.40	0.00
24640	242.20	242.20	0.00
24650	242.00	242.00	0.00
24660	241.80	241.80	0.00
24670	241.60	241.60	0.00
24680	241.40	241.40	0.00
24690	241.20	241.20	0.00
24700	241.00	241.00	0.00
24710	240.80	240.80	0.00
24720	240.60	240.60	0.00
24730	240.40	240.40	0.00
24740	240.20	240.20	0.00
24750	240.00	240.00	0.00
24760	239.80	239.80	0.00
24770	239.60	239.60	0.00
24780	239.40	239.40	0.00
24790	239.20	239.20	0.00
24800	239.00	239.00	0.00
24810	238.80	238.80	0.00
24820	238.60	238.60	0.00
24830	238.40	238.40	0.00
24840	238.20	238.20	0.00
24850	238.00	238.00	0.00
24860	237.80	237.80	0.00
24870	237.60	237.60	0.00
24880	237.40	237.40	0.00
24890	237.20	237.20	0.00
24900	237.00	237.00	0.00
24910	236.80	236.80	0.00
24920	236.60	236.60	0.00
24930	236.40	236.40	0.00
24940	236.20	236.20	0.00
24950	236.00	236.00	0.00
24960	235.80	235.80	0.00
24970	235.60	235.60	0.00
24980	235.40	235.40	0.00
24990	235.20	235.20	0.00
25000	235.00	235.00	0.00

SPINE ROAD 3 - LONGSECTION
SCALE: H 1:500, V 1:100, DATUM: 190.000

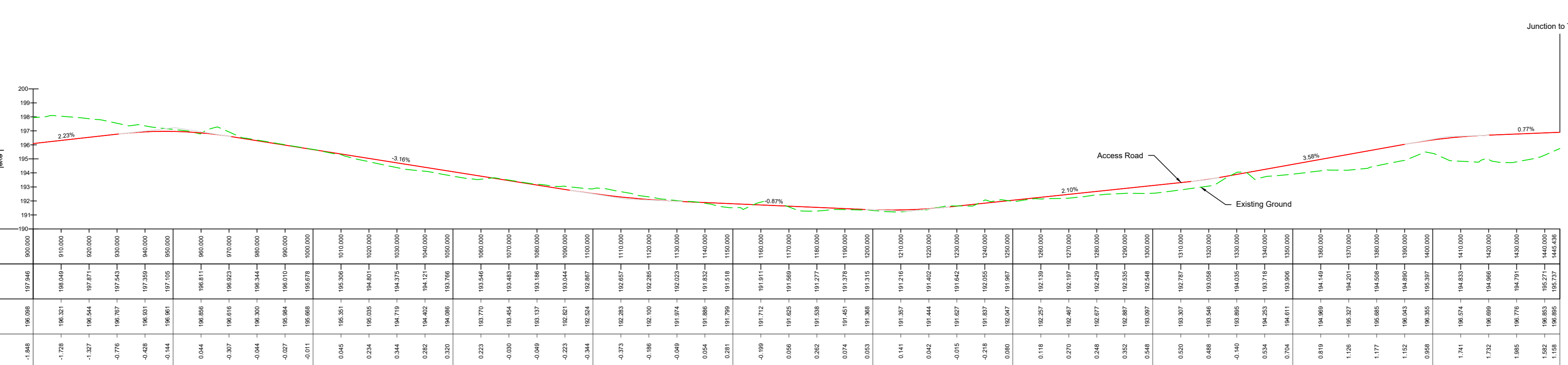

Chainage	Existing Levels	Proposed Levels	Level Difference
25000	235.00	235.00	0.00
25010	234.80	234.80	0.00
25020	234.60	234.60	0.00
25030	234.40	234.40	0.00
25040	234.20	234.20	0.00
25050	234.00	234.00	0.00
25060	233.80	233.80	0.00
25070	233.60	233.60	0.00
25080	233.40	233.40	0.00
25090	233.20	233.20	0.00
25100	233.00	233.00	0.00
25110	232.80	232.80	0.00
25120	232.60	232.60	0.00
25130	232.40	232.40	0.00
25140	232.20	232.20	0.00
25150	232.00	232.00	0.00
25160	231.80	231.80	0.00
25170	231.60	231.60	0.00
25180	231.40	231.40	0.00
25190	231.20	231.20	0.00
25200	231.00	231.00	0.00
25210	230.80	230.80	0.00
25220	230.60	230.60	0.00
25230	230.40	230.40	0.00
25240	230.20	230.20	0.00
25250	230.00	230.00	0.00
25260	229.80	229.80	0.00
25270	229.60	229.60	0.00
25280	229.40	229.40	0.00
25290	229.20	229.20	0.00
25300	229.00	229.00	0.00
25310	228.80	228.80	0.00
25320	228.60	228.60	0.00
25330	228.40	228.40	0.00
25340	228.20	228.20	0.00
25350	228.00	228.00	0.00
25360	227.80	227.80	0.00
25370	227.60	227.60	0.00
25380	227.40	227.40	0.00
25390	227.20	227.20	0.00
25400	227.00	227.00	0.00
25410	226.80	226.80	0.00
25420	226.60	226.60	0.00
25430	226.40	226.40	0.00
25440	226.20	226.20	0.00
25450	226.00	226.00	0.00
25460	225.80	225.80	0.00
25470	225.60	225.60	0.00
25480	225.40	225.40	0.00
25490	225.20	225.20	0.00
25500	225.00	225.00	0.00

SPINE ROAD 3 - LONGSECTION (CONTINUED)
SCALE: H 1:500, V 1:100, DATUM: 190.000

- Notes:**
1. All drawings are to be read in conjunction with all relevant Specifications, Bills of Materials, Architectural, Services and Engineering drawings.
 2. Any discrepancies between these documents shall be brought to the attention of the Engineer.
 3. All dimensions are in millimetres unless noted otherwise.
 4. All levels are in metres related to Ordnance Datum.
 5. Drawings are not to be scaled.
 6. The finished layout may be subject to micro-siting due to unforeseen ground conditions. The extent of flexibility will be site specific and should generally not extend beyond 20 metres.

- Legend:**
- Existing Ground Profile
 - Proposed Access Road Profile

- Reference Drawings:**
- 19107-5032 Road Alignment Locations
 - 19107-5005 Site Layout Master Sheet
 - 19107-5026 Culvert Crossing Details

Issue No.	Issue Date	Issue Description	By	Checked	Reviewed
A	03.07.2019	Issued For Planning	JK	CM	HRB

Project: Carnwagwan Wind Farm

Title: Road Alignment Locations - Sheet 5

Client: **COILLTE**

Malachy Walsh and Partners Consulting Engineers
Cork | Tralee | London | Limerick

Reese Point, Binnervilla, Tralee, Co. Kerry. Tel: +353 (0)69 9123404. Fax: +353 (0)69 1125255. E-mail: sales@mwpe.ie

Scale(s) (A1)	As Shown	Dwg No.	19107-5037	Rev.	A
Drawn	JK	04.11.2019			
Chk'd (DD)	JK	04.11.2019			
Chk'd (Eng)	PK	07.11.2019			
Approved	JK	07.11.2019			